

3/8"sq. CORDLESS RATCHET WRENCH SET

Compact Like a Mini Air Ratchet.
Delivers High-Speed Rotation!
Reduces Stress During Repetitive Work and in Tight Spaces.

Length
220mm

No-load speed
320 rpm

This ultra-compact, lightweight cordless ratchet reduces worker fatigue with a natural feel similar to air ratchets. Its high-speed rotation—about 1.4 times faster* than conventional models—helps cut down work time.

*Compared to JAR353.



Ultra-compact and lightweight
for easy handling



Equipped with an LED light linked to the trigger switch to improve visibility of the target object



Charging indicator informs you of the battery status

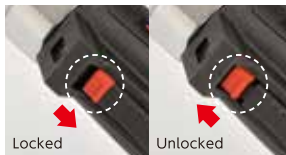

Adopts a secure locking mechanism to prevent accidental operation



3/8"sq. CORDLESS RATCHET WRENCH SET

No.	Torque		No-load speed (rpm)	Lithium-ion battery	Length (mm)	Height (mm)	Width (mm)	Weight (g)
	Electric (N·m)	Manual (N·m)						
JTRE330	3N·m	200N·m	320	3.6V/2.5Ah	220	44	35	500

- Ultra-compact and lightweight body makes it easy to use even in tight spaces.
- Improves the efficiency of fast turning work with high speed rotation.
- The LED light linked to the trigger switch can illuminate the area around the work area.
- Comes with a charging indicator that shows the battery status when in use or charging.
- Features a locking mechanism to prevent accidental operation when stored or placed temporarily.
- Battery: Built-in (cannot be removed)
- Charging port: USB Type C, charging time: approx. 60 minutes
- Using environment temperature: 0 to 40°C
- Accessories/USB charging cable (charger not included)

*When a large force is required, such as when starting to loosen, lock the trigger switch and use it as a ratchet handle.

*Charging time varies depending on battery condition and charging environment.

*Replacement parts are available. Please contact your dealer for details.



- Use protective equipment such as safety glasses, a mask, and earplugs.
- Charge using the included USB cable.
- Cannot be charged with a quick charger. (Recommended charger conditions: 5V2A)



Weight:
Approx. **33%**
less than
our previous
product

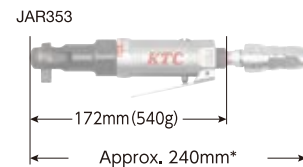

*This may vary slightly depending on how tightly the air coupler is tightened and the size of the coupler.

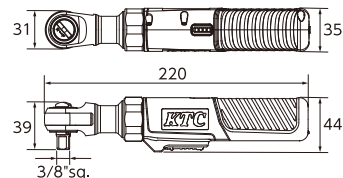

Cordless impact wrench set

For tightening and loosening light maintenance and interior maintenance work!



Features

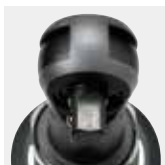
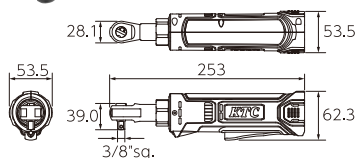

H-shaped head



3/8"sq. CORDLESS RATCHET WRENCH SET

No.	Torque		No-load speed (rpm)	Lithium-ion battery	Length (mm)	Height (mm)	Width (mm)	Weight (g)
	Max(N·m)	Practical(N·m)						
JTRE310	34	30	190	7.2V/2.0Ah	253	62.3	53.5	750

[Set contents] Main unit (JRE310) x 1, battery pack x 1, lithium-ion dedicated charger (JHE072) x 1

- When the battery level falls below 30%, the LED light will flash to let you know it's time to charge.
- Uses a teasing throttle that allows the rotation to be adjusted by how hard the throttle lever is pulled.
- The tip of the head is H-shaped to prevent the head from opening when overloaded.
- *When using continuously, the LED may flash temporarily due to voltage drop even if there is sufficient battery power remaining.
- *When a large amount of force is required, such as when starting to loosen, use the throttle lever as a ratchet handle without holding the throttle lever.
(Operating the ratchet while it is in operation may damage the ratchet.)
- *Batteries and chargers are available as replacement parts.
- *Batteries and chargers are not covered by repairs.

For removing various covers from automobiles!



Comes with a special plastic case (W350xD285xH90)

Included bits (4 pieces)

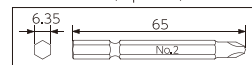

Applicable Bits

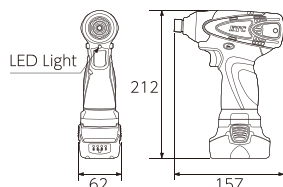
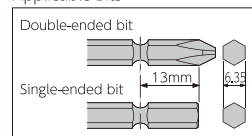

1/4"sq. CORDLESS IMPACT SCREWDRIVER SET

No.	Torque		No-load speed (rpm)	Lithium-ion battery	Length (mm)	Height (mm)	Width (mm)	Weight (g)
	Max(N·m)	Practical(N·m)						
JTAE115A	110(When fully charged at 20°C)	110	0~2,500	14.4V/2.0Ah	157	212	62	1.1

[Set contents] Main unit (JAE101) x 1, battery x 2, charger (JHE180G) x 1, power cord x 1, No. 2 cross bits x 4, plastic case (W350 x D285 x H90) x 1

- Small and lightweight type that uses a lithium-ion battery.
- Comes with four No. 2 cross bits.
- Equipped with an LED light that can illuminate the work target.
- Rapid 40 minute charging.
- *The practical torque value is a reference value and may vary depending on the usage environment.
- *Charging time varies depending on battery condition and charging environment.
- *Batteries and chargers are available as replacement parts.
- *Batteries and chargers are not covered by repairs.

Includes 2 batteries with easy-to-read charge indicators!

Fully charged

Needs charging

Needs charging

Needs charging

Needs charging

Needs charging

Needs charging

Needs charging

Needs charging

Needs charging

Needs charging

Needs charging

Needs charging

Needs charging

Needs charging

Needs charging

Needs charging

Needs charging

Needs charging

Needs charging

Needs charging

Needs charging

Needs charging

Needs charging

Needs charging

Needs charging

Needs charging

Needs charging

Needs charging

Needs charging

Needs charging

Needs charging

Needs charging

Needs charging

Needs charging

Needs charging

Needs charging

Needs charging

Needs charging

Needs charging

Needs charging

Needs charging

Needs charging

Needs charging

Needs charging

Needs charging

Needs charging

Needs charging

Needs charging

Needs charging

For removing engine accessories!



Comes with a special plastic case (W350xD285xH90)

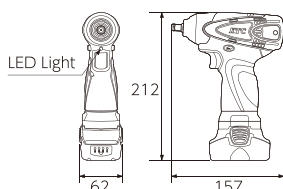

3/8"sq. CORDLESS IMPACT WRENCH SET

No.	Torque		No-load speed (rpm)	Lithium-ion battery	Length (mm)	Height (mm)	Width (mm)	Weight (g)
	Max(N·m)	Practical(N·m)						
JTAE315A	110(When fully charged at 20°C)	110	0~2,500	14.4V/2.0Ah	157	212	62	1.1

[Set contents] Main unit (JAE301) x 1, battery x 2, charger (JHE180G) x 1, power cord x 1, plastic case (W350 x D285 x H90) x 1

- Small and lightweight type that uses a lithium-ion battery.
- Equipped with an LED light that can illuminate the work target.
- Rapid 40 minute charging.
- *The practical torque value is a reference value and may vary depending on the usage environment.
- *Charging time varies depending on battery condition and charging environment.
- *Batteries and chargers are available as replacement parts.
- *Batteries and chargers are not covered by repairs.

Includes 2 batteries with easy-to-read charge indicators!

Fully charged

Needs charging

Needs charging

Needs charging

Needs charging

Needs charging

Needs charging

Needs charging

Needs charging

Needs charging

Needs charging

Needs charging

Needs charging

Needs charging

Needs charging

Needs charging

Needs charging

Needs charging

Needs charging

Needs charging

Needs charging

Needs charging

Needs charging

Needs charging

Needs charging

Needs charging

KTC KYOTO TOOL CO., LTD.

128 Sayama-Shinkaichi, Kumiyama Kuse-gun, Kyoto 613-0034, Japan

Official site: en.ktc.jp

- All sizes on this leaflet are indicated as millimeter unless mentioned.
- There might be size differences between those mentioned on this leaflet and the actual products for the product tolerance.
- Product design might be changed for the improvement without the notifications.

