



Digital caliper wireless model
No.GNN15, GNN20, GNN30

User's manual

The following symbols are used in this user's manual.

- Prohibited actions**
The mark that prohibits the act in handling the product.
- Notes**
Symbols that call attention to product handling
- Must conduct**
Symbols that represent actions that must be performed when handling products
- Confirmation matter**
A mark that indicates items to be checked in advance when handling a product, and application of usage.

Safety precautions

Please read this "Safety Precautions" carefully before use, and use the product correctly.

Warning May cause death or serious injury.		
Symbols	Important matter	Harm and damage
⚠	●Stop using the battery if it leaks fluid or gives off a strange smell.	There is a risk of liquid leakage, explosion, heat generation, etc. In the unlikely event that battery fluid gets on your skin or clothes, wash it off immediately with a large amount of clean water.

Note It may cause injury or property damage.		
Symbols	Important matter	Harm and damage
⚠	●Do not use for any purpose other than its intended purpose.	It may cause injury or property damage.
⚠	●Do not disassemble or modify the product.	It may cause injury or property damage.
⚠	●Do not measure when the object to be measured is rotating.	It may cause injury or property damage.
⚠	●The tips of the outer and inner measuring surfaces of the calipers are sharp, so be careful not to injure your body.	It may cause injury or property damage.
⚠	●Keep out of reach of small children.	It may cause injury or property damage.
⚠	●Do not use in humid or wet locations.	It may cause product damage.
⚠	●Do not subject the unit to strong impact such as dropping.	It may cause product or property damage.
⚠	●Do not throw the product.	It may cause product or property damage.
⚠	●Do not leave in places with high temperatures such as in direct sunlight or near heating equipment.	It may cause product damage.
⚠	●Do not drop or leave in water.	It may cause product damage.
⚠	●Do not leave the product with chemicals, seawater, moisture, etc.	It may cause product damage.
⚠	●For your safety, wear protective glasses while working.	It may cause injury.
⚠	●Do not press the button with too much force.	It may cause product damage.

Important matter

- Before using this product for the first time, wipe off the rust-preventive oil on the calipers with a soft cloth soaked in cleaning oil and dry it.
- Do not apply voltage to the product, as this may damage the circuitry.
- After use, perform rust prevention treatment. Rust can cause problems.

Packing contents

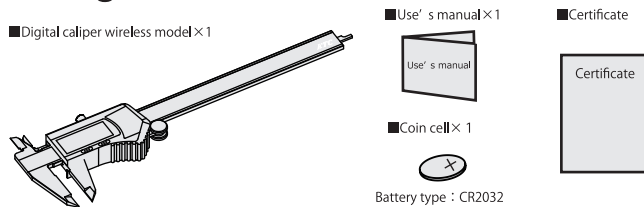

Part Names and Specifications

Part Names

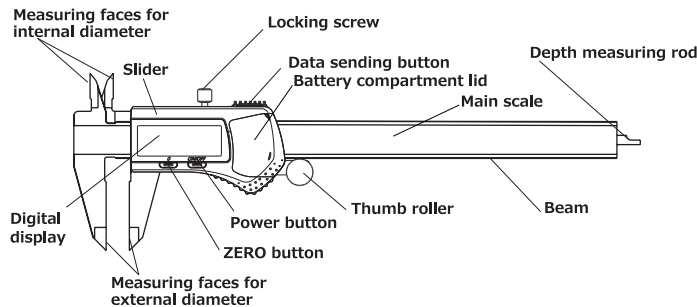

Specifications

Product's name	Digital caliper wireless model 150mm	Digital caliper wireless model 200mm	Digital caliper wireless model 300mm
Part number	GNN15	GNN20	GNN30
Measurable range	0 ~ 150mm	0 ~ 200mm	0 ~ 300mm
Minimum display value	0.01mm		
Maximum instrument error	±0.03mm		±0.04mm
Battery	Type	Coin cell(CR2032) ※Rechargeable batteries must not be used.	
	Battery life	Approximately 6 months under normal use (It depends on the actual usage)	
Usage environment	Temperature	0 ~ 40°C	
	Humidity	Less than 80% (No condensation)	
Usage environment	-10 ~ 60°C		
Communication method	Bluetooth 5.0		
Frequency bands	2.4GHz band		

Wireless notes

- The frequency band in which this product is used is used by mobile identification premises radio stations (radio stations requiring a license), specified low-power radio stations (radio stations not requiring a license), and amateur radio stations (radio stations requiring a license) used in industrial, scientific, and medical equipment such as microwave ovens and on factory production lines, etc. The following is a list of the radio stations that are in operation.
- 1 Before using this product, please make sure that there are no mobile radio stations, specified low-power radio stations, or amateur radio stations in operation nearby.
 - 2 In the unlikely event of an instance of harmful radio interference from this product to a mobile identification premises radio station, immediately stop radio transmission and take measures to avoid interference, such as installing partitions.
 - 3 If you encounter any other problems, such as harmful radio interference from this product to Specified Low Power Radio Stations for mobile identification or amateur radio stations, please contact us at the following address.
contact address : Customer contact
Reception time : 9 : 00 ~ 12 : 00/13 : 00 ~ 17 : 00
(Excluding Saturdays, Sundays and our company holidays)
TEL : 0774-46-4159 FAX : 0774-46-4359

Notes on Bluetooth®

- Radio waves generated by the Bluetooth® equipment may affect the operation of electrical devices and other equipment. Turn off the power of this product and Bluetooth® devices in the following places, as it may cause an accident.
In hospitals, near priority seats on trains, in places where flammable gas is generated, such as in airplanes, near automatic doors and fire alarms
- Please note that our company cannot take any responsibility even if information leakage occurs when connecting using Bluetooth® technology.
- This product does not guarantee wireless connection with all Bluetooth® devices. The Bluetooth® device to be connected must comply with the Bluetooth® standard specified by the Bluetooth® SIG and must be certified.
Even if the connected device conforms to the above Bluetooth® standard, phenomena such as inability to connect or differences in operation, display, or behavior may occur depending on the device's characteristics and specifications.
- Depending on the device to be connected, it may take some time before the Bluetooth® connection is possible.
- The radio equipment of this product has received technical standards conformity certification as a radio station for low-power data communication systems based on the Radio Law, so do not disassemble or modify the device.

Operations

1. Preparations

(1) Dry the surface of the main scale and check that there is no foreign matter adhering to all the measurement surfaces.

2. How to turn on/off the power

(1) Press the power button to turn on/off the power.

3. 0 point alignment

(1) Turn on the power of the caliper.
(2) Gently close the measuring faces for external diameter, press and hold the ZERO button, and when 0.00mm is displayed on the digital display, you are done.
(If the outer measuring surface is closed and 0.00mm is displayed on the digital display, zero point setting is not required.)

4. How to connect with the device

(1) Make sure that Bluetooth® connection is enabled in the device settings.
(For device settings, please refer to the instruction manual of your device.)
(2) Turn on the power of the caliper and press and hold the data sending button.
※ The device is detected while the OK icon is blinking at the bottom right of the digital display.
(3) When the device "GNN○○#XXXX" appears on the device's Bluetooth® connection screen, select it and perform pairing.
※ If the connection is successful, the Bluetooth® icon will be displayed on the upper left of the digital display.

5. How to send data

(1) Measure while connected to the device, and press the data sending button while the measured value is displayed on the digital display.

6. How to disconnect

6-1. How to disconnect from the caliper
(1) Press and hold the data sending button on the caliper for 5 sec or longer while connected.
※ When the connection is successfully disconnected, Δ blinks 3 times in the upper right corner of the digital display.
※ This method will disconnect, but the device will still have the pairing information.

6-2. How to disconnect from your device
(1) Select "GNN○○#XXXX" on the Bluetooth® setting screen on your device, and select to disconnect or delete the registration.

※ If you choose to remove the registration, you will need to pair again the next time you use it.
Supplement : Turning off the Bluetooth® function of your device will also disconnect the caliper, but other devices connected to your device via Bluetooth® will also be disconnected.

7. Battery replacement

(1) After confirming that the power is off, open the battery compartment lid by sliding it backward.

(2) Remove the old battery.

(3) Insert the new battery with the + side facing up.

(4) Slide the battery compartment lid back, press the power button and check if the power turns on.

※ The zero point may shift after battery replacement. In that case, set the zero point again.

If the display is incorrect, please reinsert the batteries.

Overview and usage of "TRASAS Settings"

■ Overview of "TRASAS Settings"

When "TRASAS Settings" is installed on a terminal such as a smartphone or tablet, the Bluetooth® function can be used to set the "device name", "transmission data method setting", and "pairing mode setting" when pairing the caliper. It can be changed.



The function and display of the application are subject to change without notice.

■ How to install "TRASAS Settings"

※ The following description is for Android.

(1) Search by entering "TRASAS Settings" in the Google Play search field.

(2) Follow the instructions on the screen to install "TRASAS Settings".

(3) A "TRASAS Settings" icon is created on the home screen.

Usage notes

■ When you want to connect to a device other than the one you connected once, if the previous device still has pairing information, it may automatically connect to the previous device.

When connecting with another device, delete the pairing information from the previously connected device.

■ When sending measured values, set the terminal keyboard to half-width.

(For the keyboard settings of your device, please refer to the instruction manual of your device.)

Brief on maintenance

Troubles	Possible Causes	Solutions	Page
No display	Poor contact	Clean the battery position	P5
Flashing display	Low voltage	Replace the battery	
No accurate measurement values appear	The zero point is incorrect.	Adjust zero points	P4
The slider does not move	Locking screw is tight.	Loosen the locking screws	—
	There are impurities on the surface of the main scale.	Wipe off with a soft cloth	P4
Unable to communicate	Bluetooth® on the terminal is not valid.	Turn on the Bluetooth® of your device	—
	Not paired.	Communicate after pairing with the device.	P4
	It is connected to another device.	OFF the Bluetooth® function of another device, cut the pairing, then pair with the device and communicate.	P5
	There are other devices that generate strong radio waves, such as microwave ovens and Wi-Fi equipment.	Turn off the equipment that generates strong radio waves or release it from this product.	—
	The distance between the device and the caliper is too far.	Close the distance between the device and the calipers. (1-5m)	—
	There is a shield between the device and the calipers.	Remove any obstructions.	—
No response when pressing buttons	An error has occurred in the computer of the calipers.	Turn off the power, reinsert the batteries, and turn on the power again.	P5

After-Sales Service & Inquiry Contact

■ Certificate of Inspection

Based on in-house standards, it indicates the result of inspection of the accuracy and performance of the product before shipping from the factory.

■ Calibration and adjustment

Checking (calibration) and adjustment of measurement results are available for a fee.

■ Issuance of "Calibration Certificate"

A calibration certificate certifies that the value indicated by a measuring instrument was calibrated using a verifier based on a standard instrument traced to international standards. The accuracy and performance of the measuring instrument can be certified externally and publicly.

The calibration certificate contains the following information:

- Inspection certificate
 - Created date
 - A declaration statement that it is traced to international standards
 - Description of calibration product (control number, product name, model number, manufacturer, manufacturing number)
 - Product name of the verification device used for calibration, model, equipment capability, date of calibration of the tester itself, and scheduled date of next calibration
- The inspection report shows the results of accuracy inspection based on the KTC standard at the shipping stage, and the calibration certificate contains the above b, to e, in addition to the inspection results.

- The copyright of this document is held by Kyoto Tool Co., Ltd.
- This product is not endorsed, sponsored or otherwise approved by Google Inc.
- Android is a registered trademark of Google Inc. in the United States and other countries.
- Google is a registered trademark of Google Inc.
- GooglePlay and Android Market are service marks of Google Inc.
- KTC, **KTC** logos, TRASAS and **TRASAS** logos is a registered trademark or trademark of Kyoto Tool Co., Ltd.
- Bluetooth® The Bluetooth word mark and logos are trademarks owned by Bluetooth SIG, Inc. and any use of such marks by Kyoto Tool Co., Ltd. is under license.
- Other company names and product names are trademarks or registered trademarks of their respective companies.

For other repair inquiries, please contact the KTC customer service or the store where you purchased the product.

Customer contact

Reception time 9:00 ~ 12:00/13:00 ~ 17:00

(Excluding Saturdays, Sundays and our company holidays)

TEL. 0774-46-4159

FAX. 0774-46-4359 URL : ktc.jp/

Seller's name and location Kyoto Tools Co., Ltd.

〒613-0034

128 Sayamashinkaichi, Kumiyama-cho, Kuse-gun, Kyoto

MEMO