

Usage

Suitable for exchanging grease used in heavy-loaded bearings of large-sized vehicle.

For exchanging grease in the hub bearings during inspection and servicing of vehicles for general use.

NOTE: Grease Can is not included GZR18.

Product Features

Wide Range of Applications

Fit for various size bearings used in automobiles (from mini-cars to large-sized Trucks) and construction machinery.

Easy handing, improved work efficiency, keeps hands clean

Grease can be exchanged easily, no skill is required.

Reduced Grease consumption by elimination waste

Only a minimal amount of grease is required. Helps saving the Grease.

Mounting Method

1. Install Inner Lid

Hold down the Inner Lid until grease comes up from Center Hole.

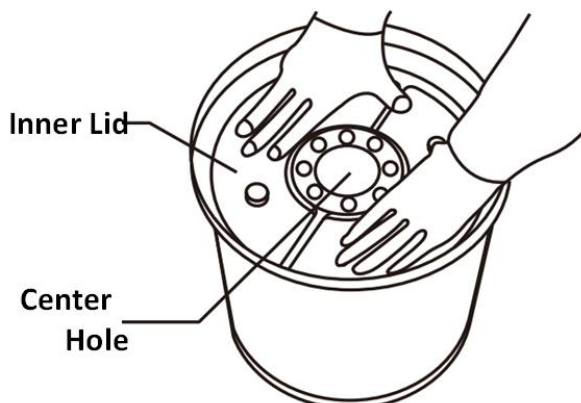

2. Install Pipe

Install Pipe into Center Hole.

Hold down the Upper Lid until it hit to edge of Grease Can.

Use Thumbscrews and fix the Upper Lid.

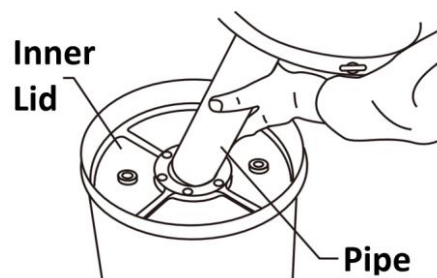

Usage Method

1. Remove an Upper Cone

Turn the Handle to Chucking position and pull up and remove the Upper Cone.

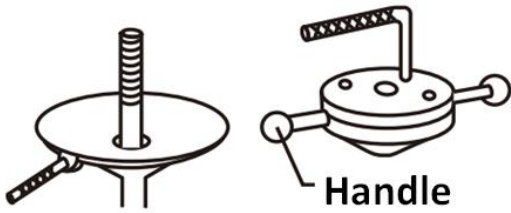

2. Install a Bearing

Setup a Bearing on the center of Lower Cone.

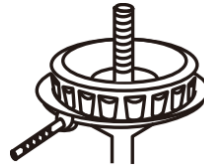

3. Chucking

Insert an Upper Cone into Guide Shaft then turn a handle and chuck it.

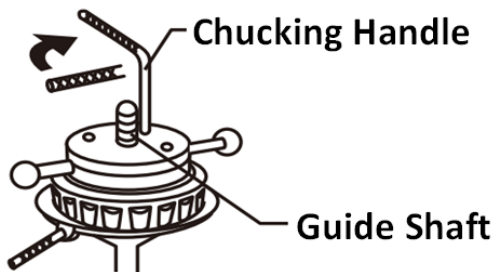

4. Retightening

Hold a Detent Handle to fix the Bearing Retightening by Chucking Handle

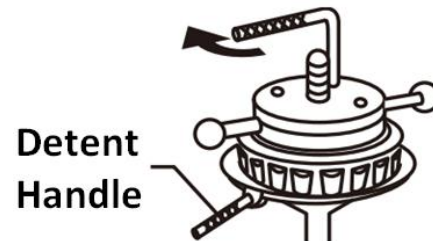

5. Change the Grease

Hold down the Lever
New grease forces out the old grease.

6. Remove a Bearing

Loosen the chuck, remove Upper Cone, and take Bearing off.

Assembly Parts for Grease Exchanger HIGHLOAD (ITEM NO: GZR182)

This Kit of replacement parts for upgrading a GZ18 grease exchanger into a “HIGHLOAD” type heavy-duty grease exchanger can be used only with the (A) type model. Adaptability can be confirmed by pressing the bellows below the lower cone and checking the Lock Nut.

