

Thank you for purchasing **KTC** ATTACHMENT FOR BRAKE BLEEDER (HONDA).
 In order to use this product safely and correctly, please be sure to read this Instruction Manual before use. (Please store this Instruction Manual with the product.)

This product is a special attachment of reservoir tank which pumps brake fluid for KTC BRAKE BLEEDER (ABX70).

CAUTION



CAUTION

- Please follow the maintenance instruction of each car maker.
- Do not use except for pumping brake fluid for ABX70.
- Please refer to the special instruction manual for the work procedure of Brake Bleeder.
- Remove residual pressure before detaching and replacing.
- Do not use the product when the product or object to be worked on is defective in any way such as it has crack or distortion.
- Immediately stop the operation if brake fluid leaks while pumping.
- Operate with 5° - 40° environmental temperature
- Do not apply external force to the attachment after it is attached to the reservoir tank.
- Do not pull hoses etc while pumping.
- In case brake fluid spills, wipe away with cloth etc and wash it in water
- Do not apply pressure or shock to the product. Otherwise, it may cause the product to malfunction.
- Never attempt to disassemble or remodel.

Application

Item No.	ABX70-F1	ABX70-F2	ABX70-G1	ABX70-G2	ABX70-G3	ABX70-H1
Application	Reservoir tank for Mazda (ID 36mm)	Reservoir tank for Daihatsu (ID 60mm)	Reservoir tank for Toyota (ID 42.5mm)	Reservoir tank for Honda (ID 56mm)	Reservoir tank for Daihatsu (ID 54mm)	Reservoir tank for Honda (ID 75mm)
Figure						
Remarks			Enable combination: Seal cap assy (Refer to Pic.2) + Clamp E1 (included with ABX70)	Use Seal Cap assy + Clamp E1 for the type of master cylinder and reservoir tank fixed by hose band.	Use Seal Cap assy + Clamp E1 for the type of master cylinder and reservoir tank fixed by hose band. (With the wire for preventions of improper use)	

How to use

ABX70-G1, ABX70-G2, ABX70-G3

- ① Remove cap of reservoir tank and the strainers etc.
- ② Unlock Clamp assy of the attachment and separate, then take out the Seal Cap assy.(Pic.2)
- ③ Tuck in Seal Cap assy to the suction mouth of reservoir tank. (Pic.3)
 (Note) Tuck in evenly till there is no space between Seal Cap assy and reservoir tank.
- ④ Attach the Clam assy on the Seal Cap. (Pic.4)
 (Note) Make sure that Clamp assy is fit to reservoir tank with lifting it up and down.
 (Note) Make sure you lock Clamp assy.
- ⑤ Connect Brake Bleeder to coupler and pump the brake fluid.
 (Note) Insert coupler straight or cannot be attached.
 (Note) Make sure the coupler is locked with pulling the socket coupler lightly.
 (Note) There is no problem, if the position of the seal part moves up when applying pressure.
 (Note) There is no problem, if the gap of the clamp moves up when applying pressure.
 (Note) The more the seal part moves, the more the fluid level moves up, so adjust the fluid level after operating.
 (Note) If not attached properly, brake fluid will scatter while pumping.
 (Note) Immediately stop the operation if you see brake fluid ooze and leak, then reattach the attachment.
 (Note) Use in the same item number combinations for Clamp assy and Seal Cap Assy.

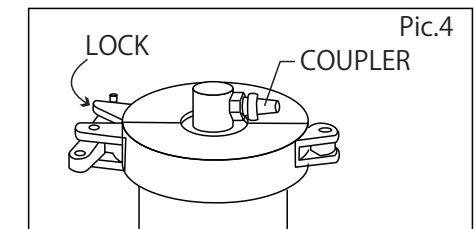
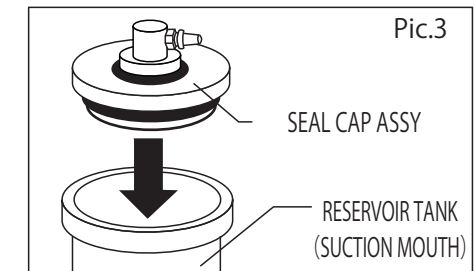
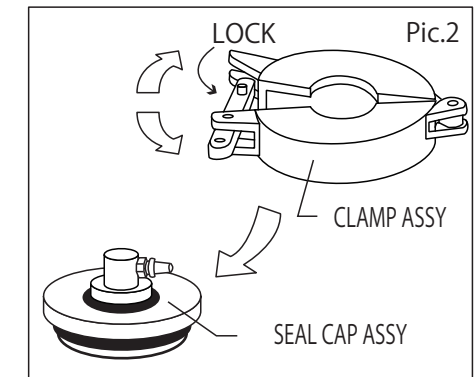

ABX70-H1

- ① Remove the cap of the reservoir tank and strainer.
- ② Tuck in the attachment to the suction mouth of reservoir tank. (Pic.5)
 (Note) Tuck in evenly till there is no space between the attachment and reservoir tank.
- ③ Attach Clamp E1 included with Brake Bleeder on the attachment. (Pic.6)
 (Note) How to attach E1, refer to instruction manual for Brake Bleeder.
 (Note) When chaining, do not catch up wiring etc.
 (Note) Chain through under the master cylinder body (metal part).
- ④ Connect the coupler of Brake Bleeder and pump brake fluid.
 (Note) Insert coupler straight or cannot be attached.
 (Note) Make sure the coupler is locked with pulling the socket coupler lightly.
 (Note) There is no problem, if the position of the seal part moves up when applying.
 (Note) The more the seal part moves, the more the fluid level moves up, so adjust the fluid level after operating.
 (Note) If not attached properly, brake fluid will scatter while pumping.
 (Note) Immediately stop the operation if you see brake fluid ooze and leak, then reattach the attachment.

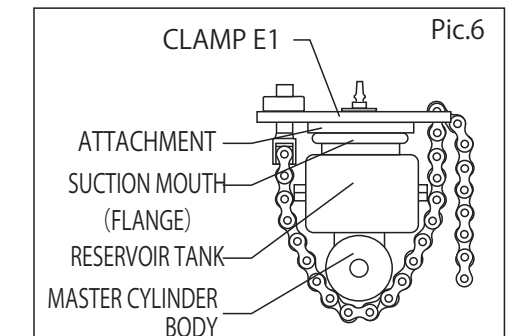
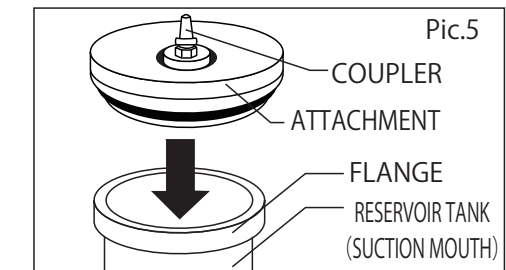

Maintenance and storing

- Wipe the product with the clean cloth and store.
- If there is an attachment case, keep it in a case.